

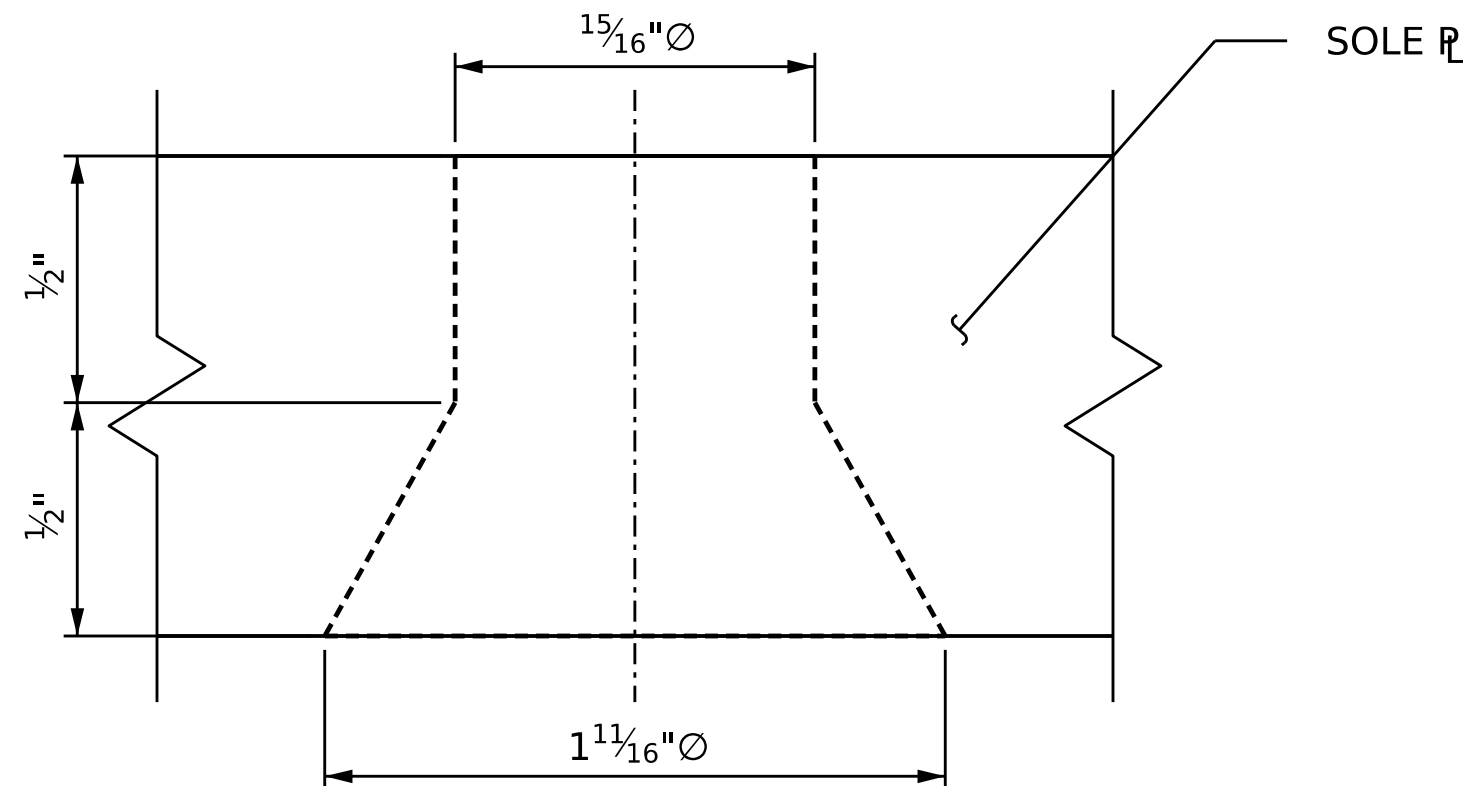

AT THE APPROVAL OF THE ENGINEER, THE OPTIONAL BOLTED SOLE PLATE MAY BE USED AT NO ADDITIONAL COST TO THE DEPARTMENT.

BRIDGE NO. 11+67.50 -L-

DETAIL B

(10 REQ'D)  
EXPANSION

(10 REQ'D)  
FIXED

(10 REQ'D)  
EXPANSION

(10 REQ'D)  
FIXED

STD. TB BRG TYPEII